

Safety Information for Pneumatic Nailers

This page contains important safety information for those who handle pneumatic nailers. Please read this information carefully and use the nailers safely.

READ AND UNDERSTAND THE INSTRUCTION MANUAL



Improper and unsafe use of a nailer may result in serious injury.

Please read the owner’s manual enclosed with the product thoroughly before using any nailer.

For a downloadable pdf version of an owner’s manual, please visit the product detail page, click on the link for Owner’s Manual.

CHOOSE THE TRIGGERING METHOD BEST SUITED FOR YOUR SPECIFIC NEEDS

Hitachi offers different types of triggering methods for pneumatic nailers.

Give careful consideration to your specific needs, and select the most effective triggering method for your particular job.

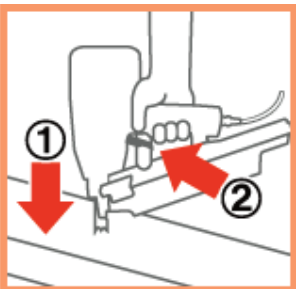

-INTERMITTENT OPERATION METHOD (Trigger fire):

This method is best suited for exact firing when rapid nailing is not required. An optional sequential trip mechanism kit (single shot parts) that can convert the triggering system into a dedicated intermittent operation mechanism is available. Please refer to the owner’s manual located on your tool’s [product page](#) for further information.

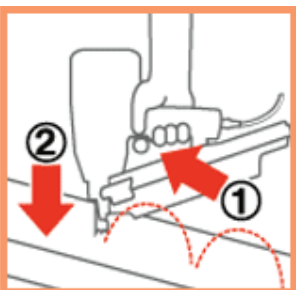

-CONTINUOUS OPERATION METHOD (Push lever fire):

This method is best suited for high-volume or rapid nailing when exact firing is not required.

Improper use of this continuous operation method may cause an unwanted second nail to be driven if the push lever is unintentionally allowed to re-contact the workpiece following recoil (“double fire”). Pay special attention to the proper use of the tool in order to avoid “double fire”. Please refer to the owner’s manual located on your tool’s [product page](#) for further information.

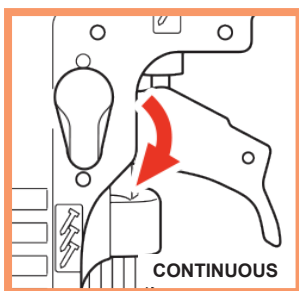
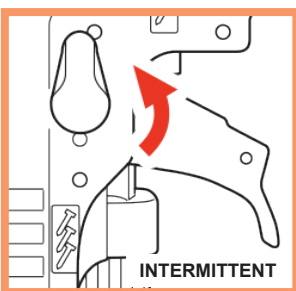

-Switching device for intermittent operation and continuous operation:

Some models can switch modes between intermittent operation and continuous operation. Please make sure that the switching device is set at the proper position for the selected triggering method.

WEAR SAFETY GLASSES



Fasteners and debris may sometimes fly towards users during operation. Always wear safety glasses in compliance with ANSI Z87.1, which protects against flying particles from both the front and the side.

KEEP FINGER OFF THE TRIGGER



Always keep your finger away from the trigger when not driving fasteners, even if you think no fasteners are loaded. Never carry the nailer with your finger on trigger.

If the trigger is pulled unnecessarily, you could drive a fastener unintentionally and injure yourself or someone else.

NEVER POINT TOOL AT YOURSELF OR OTHERS



Never point the tool toward yourself or anyone else, even if you think no fasteners are loaded.



Keep hands and other body parts away from push lever.

USE PROPERLY



Do not exceed the maximum recommended air pressure.

USE PROPERLY



Never use any bottled gases. Use only compressed air.

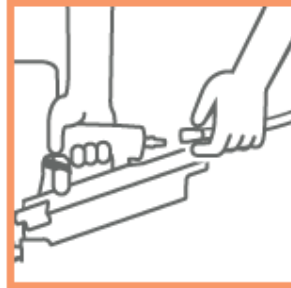

Disconnect air hose when not working.

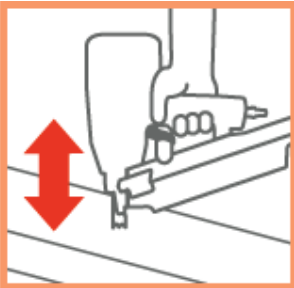

Make sure the push lever operates properly before use.



Never alter or modify the tool.

Quick Check List for use: YOU MUST...

BEFORE use,	read owner's manual.	<input type="checkbox"/>
	choose the most effective trigger system for your specific needs.	<input type="checkbox"/>
	check to make sure that the switching device is set to the intended position.	<input type="checkbox"/>
	wear safety glasses.	<input type="checkbox"/>
	never exceed maximum recommended air pressure.	<input type="checkbox"/>
	never use bottled gases.	<input type="checkbox"/>
	make sure the push lever operates properly.	<input type="checkbox"/>
DURING use,	always remove finger from trigger when not driving fasteners.	<input type="checkbox"/>
	never point the tool toward anybody.	<input type="checkbox"/>
	keep hands and other body parts away from push lever.	<input type="checkbox"/>
	be careful of recoil and "double fire."	<input type="checkbox"/>
AFTER use,	immediately disconnect air hose.	<input type="checkbox"/>
OUT OF use,	never alter or modify the tool.	<input type="checkbox"/>

If you have any questions or comments on this safety information, please contact the following:

Contact Customer Service

Service Department, Hitachi Koki U.S.A.,Ltd.,
1111 Broadway Ave., Braselton, Georgia 30517, U.S.A.
1-866-775-9429