

HITACHI

LIST NO. 0338

ELECTRIC TOOL PARTS LIST

■ BELT SANDER
Model SB 10T

1993 · 10 · 1
(E3)

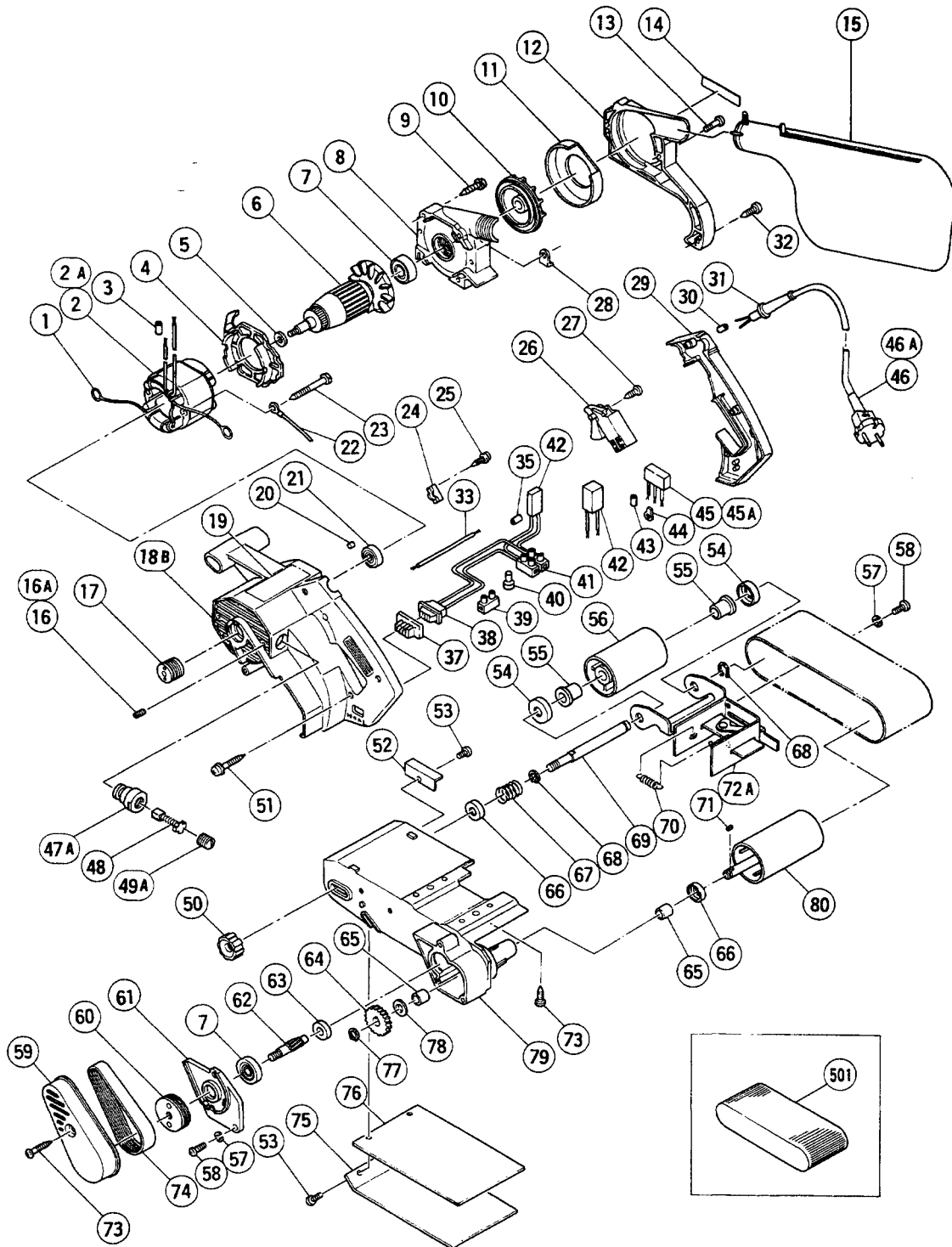

PARTS

SB 10T

ITEM NO.	CODE NO.	DESCRIPTION	NO. USED	REMARKS
1	930-703	BRUSH TERMINAL	2	
*	2	340-104C	1	INCLUD.1,3
*	2	340-104D	1	INCLUD.1,3
	2	340-104E	1	INCLUD.1,3
	2	340-104F	1	INCLUD.1,3
*	2	340-104K	1	INCLUD.1 FOR SUI,NZL
*	2	953-142J	1	INCLUD.1 FOR FIN
*	2	953-142H	1	INCLUD.1 FOR GBR
*	2	953-142K	1	INCLUD.1 FOR GBR
*	2A	340-104L	1	INCLUD.1 FOR ITA,FRG,FRA,HOL,DEN,POR, ESP,SWE,AUT,SAF,NOR
	3	981-373	1	TUBE (D)
	4	953-185	1	FAN GUIDE
	5	954-234	1	BEARING WASHER (B)
*	6	953-145U	1	ARMATURE ASS'Y 110V - 115V INCLUD.5,7,21
*	6	953-145D	1	ARMATURE 120V - 127V
*	6	953-145E	1	ARMATURE 220V
*	6	953-145F	1	ARMATURE 230V - 240V FOR KUW,NGU,AUS,GBR,ITA,FRG,HOL,DEN, SWE,AUT,NOR,ESP
	7	620-0VV	2	BALL BEARING 6200VVCMP2S
	8	953-146	1	INNER COVER
	9	986-011	4	TAPPING SCREW (W/SP. WASHER) D5X30
	10	953-053	1	DUST FAN
	11	953-158	1	DUST GUIDE
	12	953-157	1	DUST COVER
	13	949-223	2	MACHINE SCREW M4X25 (10 PCS.)
	14	957-561	1	HITACHI LABEL
	15	953-078	1	DUST BAG
	16	932-668	2	HEX. SOCKET SET SCREW M4X10 TILL 8.1988
	16A	938-477	2	HEX. SOCKET SET SCREW M5X8 SINCE 7.1988
	17	987-532	1	PULLEY (A)
	18B	985-590	1	HOUSING ASS'Y INCLUD.16A,47A
	19		1	NAME PLATE
	20	931-701	1	BEARING LOCK
	21	629-VVM	1	BALL BEARING 629VVMC2EPS2L
*	22	953-033	1	INTERNAL WIRE FOR SUI
*	22	961-421Z	1	INTERNAL WIRE FOR FIN
	23	953-174	2	HEX. HD. TAPPING SCREW D5X55
	24	937-631	1	CORD CLIP
	25	984-750	2	TAPPING SCREW (W/FLANGE) D4X16
*	26	931-573	1	SWITCH (2P PILLAR TYPE) W/LOCK
*	26	953-178	1	SWITCH (2P PILLAR TYPE) W/SAFETY LOCK FOR FRA
	27	954-017	1	TAPPING SCREW D4X12
	28	953-169	1	PLATE
	29	953-164	1	HANDLE COVER
*	30	981-373	2	TUBE (D) FOR CORD
*	31	958-049Z	1	CORD ARMOR D8.2
*	31	940-778	1	CORD ARMOR D10.7
	32	958-705	1	TAPPING SCREW D4X25
	33		1	INTERNAL WIRE
	35	981-373	1	TUBE (D)

*: ALTERNATIVE PARTS

PARTS

SB 10T

ITEM NO.	CODE NO.	DESCRIPTION	NO. USED	REMARKS
37	971-792	SLIDE SWITCH COVER	1	
* 38	953-171	SLIDE SWITCH (1P SOLDER TYPE)	1	
* 38	995-582	SLIDE SWITCH (1P SOLDER TYPE)	1	FOR USA
* 39	938-307Z	PILLAR TERMINAL	1	FOR FIN
40	959-140	CONNECTOR 50091 (10 PCS.)	2	
* 41	958-308Z	PILLAR TERMINAL (A)	1	FOR USA
* 42	956-613	DIODE 100V - 127V	1	
* 42	956-614	DIODE 200V - 240V	1	
* 42	953-250P	DIODE 115V	1	FOR CAN,USA
* 42		CONTROLLER CIRCUIT 240V	1	FOR AUS
* 43	981-373	TUBE (D)	2	FOR NOISE SUPPRESSOR
* 44	938-108	TERMINAL	1	FOR NOISE SUPPRESSOR
* 45	980-283Z	NOISE SUPPRESSOR	1	FOR SUI
* 45A	994-273	NOISE SUPPRESSOR	1	
* 46	500-201Z	CORD	1	(CORD ARMOR D10.7)
* 46	500-223Z	CORD	1	(CORD ARMOR D10.7) FOR KUW SIN
* 46	500-226Z	CORD	1	(CORD ARMOR D8.2) FOR NGU,NZL,AUS
* 46	500-231Z	CORD	1	(CORD ARMOR D8.2) FOR SAF
* 46	500-234Z	CORD	1	(CORD ARMOR D8.2) FOR ITA,FRG,FRA, HOL,DEN,AUT,INA,SUR
* 46	500-237Z	CORD	1	(CORD ARMOR D8.2) FOR GBR (110V)
* 46	500-240Z	CORD	1	(CORD ARMOR D8.2) FOR USA,CAN
* 46	500-245Z	CORD	1	(CORD ARMOR D10.7) FOR SYR
* 46	500-247Z	CORD	1	(CORD ARMOR D10.7) FOR FIN,SWE,NOR
* 46	500-248Z	CORD	1	(CORD ARMOR D10.7) FOR SUI
* 46A	500-435Z	CORD	1	(CORD ARMOR D8.2) FOR GBR (240V)
47A	958-900	BRUSH HOLDER	2	
48	999-043	CARBON BRUSH (1 PAIR)	2	
49A	945-181	BRUSH CAP	2	
50	995-578	KNOB NUT	1	
51	956-636	TAPPING SCREW (W/WASHER) D4X25	3	
52	953-158	STRIKING GUIDE	1	
53	949-216	MACHINE SCREW M4X10 (10 PCS.)	3	
54	953-043	WASHER	2	
55	953-042	METAL	2	
56	995-586	IDLE PULLEY ASS'Y	1	INCLUD.55
57	949-453	SPRING WASHER M4 (10 PCS.)	5	
58	949-218	MACHINE SCREW M4X14 (10 PCS.)	5	
59	953-155	BELT COVER	1	
60	953-154	PULLEY (B)	1	
61	953-153	GEAR COVER	1	
62	953-152	PINION	1	
63	935-522	METAL	1	
64	995-576	GEAR	1	
65	953-175	METAL D10X14X12	2	
66	953-161	WASHER	2	
67	995-577	SPRING	1	
68	939-542	RETAINING RING FOR D12 SHAFT (10 PCS.)	2	
69	995-587	SHAFT	1	
70	953-083	SPRING	1	
71	944-109	FEATHER KEY 3X3X8	1	

*: ALTERNATIVE PARTS

PARTS

SB 10T

ITEM NO.	CODE NO.	DESCRIPTION	NO. USED	REMARKS
72A	995-585	FORK ASS'Y	1	INCLUD.70
73	954-004	TAPPING SCREW D4X16	5	
74	958-874	BELT	1	
75	995-580	SHOE PLATE	1	
76	995-579	SHOE CUSHION	1	
77	939-540	RETAINING RING FOR D10 SHAFT (10 PCS.)	1	
78	948-213	WASHER (B) D19	1	
79	995-581	BODY ASS'Y	1	INCLUD.63,65
80	995-575	DRIVE PULLEY	1	

STANDARD ACCESSORIES

ITEM NO.	CODE NO.	DESCRIPTION	NO. USED	REMARKS
501	995-552	SANDING BELTS 100X810 WA80 (10 PCS.)	1	

OPTIONAL ACCESSORIES

ITEM NO.	CODE NO.	DESCRIPTION	NO. USED	REMARKS
601	995-574	SANDING FRAME ASS'Y	1	INCLUD.602 - 606
602	995-583	ADJUSTING BOLT	1	
603	993-843	KNOB BOLT M6X14	1	
604	951-039	MACHINE SCREW (W/SP. WASHER) M4X12	2	
605	995-588	BOTTOM PLATE (A)	2	
606	995-589	BOTTOM PLATE (B)	4	
607	995-550	SANDING BELTS 100X810 WA40 (10 PCS.)	1	
608	995-551	SANDING BELTS 100X810 WA60 (10 PCS.)	1	
609	995-553	SANDING BELTS 100X810 WA100 (10 PCS.)	1	
610	995-554	SANDING BELTS 100X810 WA120 (10 PCS.)	1	
611	995-555	SANDING BELTS 100X810 WA150 (10 PCS.)	1	
612	995-556	SANDING BELTS 100X810 WA180 (10 PCS.)	1	
613	995-557	SANDING BELTS 100X810 WA240 (10 PCS.)	1	
614	995-558	SANDING BELTS 100X810 AA40 (10 PCS.)	1	
615	995-559	SANDING BELTS 100X810 AA60 (10 PCS.)	1	
616	995-580	SANDING BELTS 100X810 AA80 (10 PCS.)	1	
617	995-561	SANDING BELTS 100X810 AA100 (10 PCS.)	1	
618	995-562	SANDING BELTS 100X810 AA120 (10 PCS.)	1	
619	995-563	SANDING BELTS 100X810 AA150 (10 PCS.)	1	
620	995-564	SANDING BELTS 100X810 AA180 (10 PCS.)	1	
621	995-565	SANDING BELTS 100X810 AA240 (10 PCS.)	1	
622	995-566	SANDING BELTS 100X810 CC40 (10 PCS.)	1	
623	995-567	SANDING BELTS 100X810 CC60 (10 PCS.)	1	
624	995-568	SANDING BELTS 100X810 CC80 (10 PCS.)	1	
625	995-569	SANDING BELTS 100X810 CC100 (10 PCS.)	1	
626	995-570	SANDING BELTS 100X810 CC120 (10 PCS.)	1	
627	995-571	SANDING BELTS 100X810 CC150 (10 PCS.)	1	
628	995-572	SANDING BELTS 100X810 CC180 (10 PCS.)	1	
629	995-573	SANDING BELTS 100X810 CC240 (10 PCS.)	1	

*: ALTERNATIVE PARTS